



Sherriff Road, London, NW6

£1,850 pcm

- Newly Refurbished Throughout
- Fitted Kitchen
- One Bedroom Apartment
- Bright & Airy Throughout

Sherriff Road, NW6

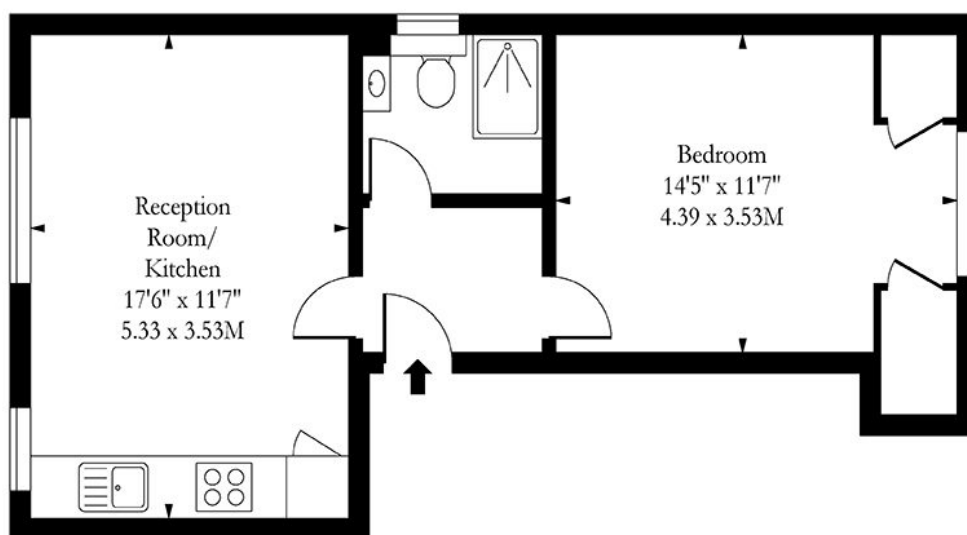

Second Floor

Approx Gross Internal Area 460 Sq Ft - 42.73 Sq M

Measured in accordance with RICS guidelines. Every attempt is made to ensure accuracy
However all measurements are approximate.

The floor plan is illustrative purposes only and is not to scale

www.tomekphotography.co.uk

