

## Lowfield Road, London, NW6

£1,850 pcm

- One Bedroom Apartment
- Bright & Airy Throughout
- Furnished
- Close to Amenities & Transport Links of West Hampstead

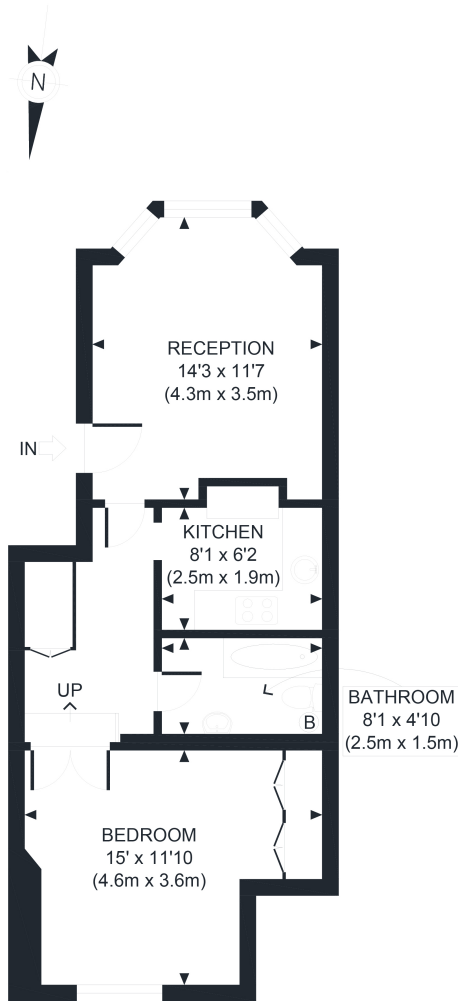

APPROX. GROSS INTERNAL FLOOR AREA 488 SQ FT / 45 SQM

Disclaimer: Floor plan measurements are approximate and are for illustrative purposes only. While we do not doubt the floor plan accuracy and completeness, you or your advisors should conduct a careful, independent investigation of the property in respect of monetary valuation

Copyright [photoplan360](#)

